



# THE NUT PLACE

6605 N. Gessner Houston, TX 77040-4015

Ph: 713-462-3147

sales@thenutplace.com

www.thenutplace.com

## GENERAL GUIDE FOR EYEBOLTS

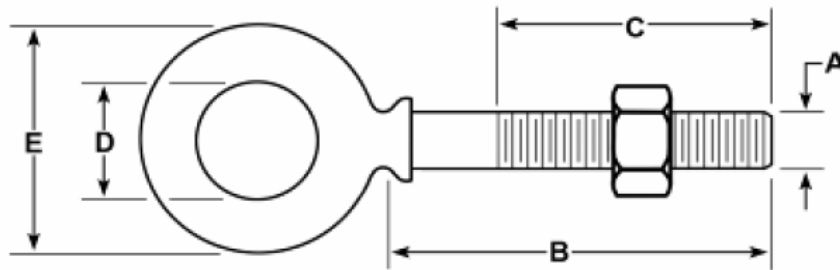

Forged carbon steel, heat treated, hot galvanized. Heavy hex nut according to ASME/ANSI B18.2.2.

Size Diameter x Shank A B	Working Load Limit in Pounds*	Approx. Weight each in Pounds	Dimensions in Inches		
			C	D	E
1/4" x 2"	650	.06	1.50	.50	.88
1/4" x 4"	650	.09	2.50	.50	.88
5/16" x 2.1/4"	1,200	.11	1.50	.63	1.13
5/16" x 4.1/4"	1,200	.15	2.50	.63	1.13
3/8" x 2.1/2"	1,500	.19	1.50	.75	1.38
3/8" x 4.1/2"	1,500	.25	2.50	.75	1.38
1/2" x 3.1/4"	2,600	.41	1.50	1.00	1.75
1/2" x 6"	2,600	.59	3.00	1.00	1.75
5/8" x 4"	5,200	.83	2.00	1.25	2.25
5/8" x 6"	5,200	1.00	3.00	1.25	2.25
3/4" x 4.1/2"	7,200	1.50	2.00	1.50	2.75
3/4" x 6"	7,200	1.70	3.00	1.50	2.75

Note: Fastening applications differ greatly, the information presented is for general guidance only and is correct to the best of our knowledge. The customer bears the responsibility to validate performance and accuracy of the data. The Nut Place, Inc. will not be held responsible for any failure that may occur from the use of this information.