



# THE NUT PLACE

6605 N. Gessner Houston, TX 77040-4015

Ph: 713-462-3147

sales@thenutplace.com

www.thenutplace.com

## SOCKET SET SCREWS

### AVAILABLE TYPES

Diameters of #1 through and including 1 1/2". Available in metric, too. Select from these styles: Cup Point, Cone Point, Oval Point, Flat Point, Nylon Tip, Brass Tip, Knurl Cup, Half Dog, and Full Dog.

Call or email us if you're looking for other diameters.

### DIAMETERS

THREAD COURSE	THREAD FINE	METRIC
2-56	04-48	2mm
3-48	6-40	3mm
4-40	8-36	5mm
5-40	10-32	6mm
6-32	12-28	8mm
8-32	1/4-28	10mm
10-24	5/16 -24	12mm
12-24	3/8 -24	14mm
1/4 -20	7/16 -20	16mm
5/16 -18	1/2 -20	18mm
3/8 -16	9/16 -18	20mm
7/16 -14	5/8 -18	22mm
1/2 -13	3/4 -16	24mm
9/16 -12	7/8 -14	27mm
5/8 -11	1 -14	30mm
3/4 -10		
7/8 -9		
1 -8		
1 1/8 -7		
1 1/4 -7		
1 3/8 -6		
1 1/2 -6		

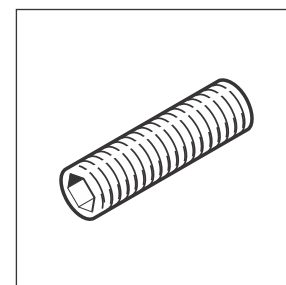

ASME/ANSI B18.3  
ASTM F912

DIN 916  
14.9 ALLOY 45H CUP POINT

ASME/ANSI B18.3  
ASTM F880  
304 STAINLESS

ASME/ANSI B18.3  
ASTM F880  
316 STAINLESS

### Fastener Finishes

Sockets are typically ordered in a black oxide or stainless steel. We also stock them with a blue nylon or zinc-plated finish. If you need to be supplied with another finish, then call or email us. We can provide finishes to your specification. We do it everyday.

### Technical Data

If you need a Technical Guide, then call or email us. We can provide your company with a Technical Guide that contains more specific information about mechanical qualities and strength.