



THE NUT PLACE

6605 N. Gessner Houston, TX 77040-4015

Ph: 713-462-3147

sales@thenutplace.com

www.thenutplace.com

REGULAR SOCKET HEADS

AVAILABLE TYPES

Diameters of #1 through and including 2 1/2". Available in metric, too. -8 pitch also available.

Call or email us if you're looking for other diameters.

DIAMETERS

THREAD COURSE	THREAD FINE	METRIC
1-72	10-32	2mm
2-56	12-28	3mm
3-48	1/4-28	5mm
4-40	5/16 -24	6mm
5-40	3/8 -24	8mm
6-32	7/16 -20	10mm
8-32	1/2 -20	12mm
10-24	9/16 -18	14mm
12-24	5/8 -18	16mm
1/4 -20	3/4 -16	18mm
5/16 -18	7/8 -14	20mm
3/8 -16	1 -14	22mm
7/16 -14	1 1/8 -12	24mm
1/2 -13	1 1/4 -12	27mm
9/16 -12	1 1/2 -12	30mm
5/8 -11		36mm
3/4 -10		39mm
7/8 -9		48mm
1 -8		
1 1/8 -7		
1 1/4 -7		
1 3/8 -6		
1 1/2 -6		
1 3/4 -5		
2 -4 1/2		
2 1/4 -4 1/2		
2 1/2 -4		

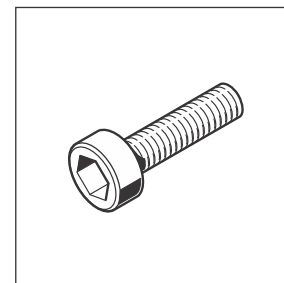

Hardness RC 38-43
ASME/ANSI B18.3
ASTM A574
Heat Treated Alloy Steel

Din 912 ISO 898-1
12.9 ALLOY STEEL

ASME/ANSI B 18.3
ASTM F837
304 STAINLESS

ASME/ANSI B18.3
ASTM F837-980
316 STAINLESS

Fastener Finishes

Sockets are typically ordered in a black oxide or stainless steel. We also stock them with a blue xylan or zinc-plated finish. If you need to be supplied with another finish, then call or email us. We can provide finishes to your specification. We do it everyday.

Technical Data

If you need a Technical Guide, then call or email us. We can provide your company with a Technical Guide that contains more specific information about mechanical qualities and strength.