



# THE NUT PLACE

6605 N. Gessner Houston, TX 77040-4015

Ph: 713-462-3147

sales@thenutplace.com

www.thenutplace.com

## REGULAR SOCKET HEADS

### AVAILABLE TYPES

Diameters of #1 through and including 2 1/2". Available in metric, too. -8 pitch also available.

Call or email us if you're looking for other diameters.

### DIAMETERS

THREAD COURSE	THREAD FINE	METRIC
1-72	10-32	2mm
2-56	12-28	3mm
3-48	1/4-28	5mm
4-40	5/16 -24	6mm
5-40	3/8 -24	8mm
6-32	7/16 -20	10mm
8-32	1/2 -20	12mm
10-24	9/16 -18	14mm
12-24	5/8 -18	16mm
1/4 -20	3/4 -16	18mm
5/16 -18	7/8 -14	20mm
3/8 -16	1 -14	22mm
7/16 -14	1 1/8 -12	24mm
1/2 -13	1 1/4 -12	27mm
9/16 -12	1 1/2 -12	30mm
5/8 -11		36mm
3/4 -10		39mm
7/8 -9		48mm
1 -8		
1 1/8 -7		
1 1/4 -7		
1 3/8 -6		
1 1/2 -6		
1 3/4 -5		
2 -4 1/2		
2 1/4 -4 1/2		
2 1/2 -4		

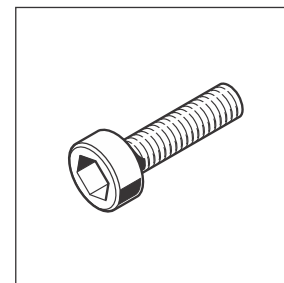

**Hardness RC 38-43**  
**ASME/ANSI B18.3**  
**ASTM A574**  
**Heat Treated Alloy Steel**

**Din 912 ISO 898-1**  
**12.9 ALLOY STEEL**

**ASME/ANSI B 18.3**  
**ASTM F837**  
**304 STAINLESS**

**ASME/ANSI B18.3**  
**ASTM F837-980**  
**316 STAINLESS**

### Fastener Finishes

Sockets are typically ordered in a black oxide or stainless steel. We also stock them with a blue xylan or zinc-plated finish. If you need to be supplied with another finish, then call or email us. We can provide finishes to your specification. We do it everyday.

### Technical Data

If you need a Technical Guide, then call or email us. We can provide your company with a Technical Guide that contains more specific information about mechanical qualities and strength.



# THE NUT PLACE

6605 N. Gessner Houston, TX 77040-4015

Ph: 713-462-3147

sales@thenutplace.com

www.thenutplace.com

## BUTTON HEAD SOCKET HEADS

### AVAILABLE TYPES

Diameters available in standard and metric.

Call or email us if you're looking for other diameters..

### DIAMETERS

THREAD COURSE	THREAD FINE	METRIC
2-56	10-32	2mm
3-48	12-28	3mm
4-40	1/4-28	5mm
5-40	5/16 -24	6mm
6-32	3/8 -24	8mm
8-32	7/16 -20	10mm
10-24	1/2 -20	12mm
12-24		
1/4 -20		
5/16 -18		
3/8 -16		
7/16 -14		
1/2 -13		
9/16 -12		
5/8 -11		

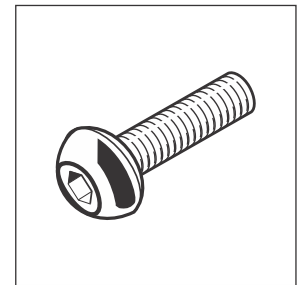

**ASME/ANSI B18.3  
ASTM F835**

**EN ISO 7380  
12.9 ALLOY STEEL**

**ASME/ANSI B18.3  
ASTM F879  
304 STAINLESS**

### Fastener Finishes

Sockets are typically ordered in a black oxide or stainless steel. We also stock them with a blue xylan or zinc-plated finish. If you need to be supplied with another finish, then call or email us. We can provide finishes to your specification. We do it everyday.

### Technical Data

If you need a Technical Guide, then call or email us. We can provide your company with a Technical Guide that contains more specific information about mechanical qualities and strength.



# THE NUT PLACE

6605 N. Gessner Houston, TX 77040-4015

Ph: 713-462-3147

sales@thenutplace.com

www.thenutplace.com

## FLAT HEAD SOCKET HEADS

### AVAILABLE TYPES

Diameters available in standard and metric.

Call or email us if you're looking for other diameters..

### DIAMETERS

THREAD COURSE	THREAD FINE	METRIC
2-56	6-40	2mm
4-40	8-36	3mm
5-40	10-32	5mm
6-32	12-28	6mm
8-32	1/4-28	8mm
10-24	5/16 -24	10mm
12-24	3/8 -24	12mm
1/4 -20	7/16 -20	14mm
5/16 -18	1/2 -20	16mm
3/8 -16	9/16 -18	18mm
7/16 -14	5/8 -18	20mm
1/2 -13	3/4 -16	
9/16 -12	7/8 -14	
5/8 -11	1 -14	
3/4 -10		
7/8 -9		
1 -8		
1 1/8 -7		
1 1/4 -7		

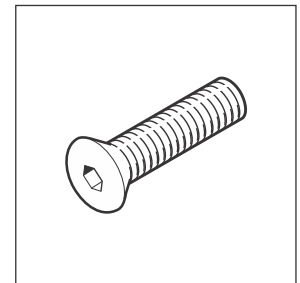

**ASME/ANSI B18.3  
ASTM F835**

**DIN 7991  
12.9 ALLOY STEEL**

**ASME/ANSI B18.3  
ASTM F879  
304 STAINLESS**

### Fastener Finishes

Sockets are typically ordered in a black oxide or stainless steel. We also stock them with a blue xylan or zinc-plated finish. If you need to be supplied with another finish, then call or email us. We can provide finishes to your specification. We do it everyday.

### Technical Data

If you need a Technical Guide, then call or email us. We can provide your company with a Technical Guide that contains more specific information about mechanical qualities and strength.



# THE NUT PLACE

6605 N. Gessner Houston, TX 77040-4015

Ph: 713-462-3147

sales@thenutplace.com

www.thenutplace.com

## SOCKET SET SCREWS

### AVAILABLE TYPES

Diameters of #1 through and including 1 1/2". Available in metric, too. Select from these styles: Cup Point, Cone Point, Oval Point, Flat Point, Nylon Tip, Brass Tip, Knurl Cup, Half Dog, and Full Dog.

Call or email us if you're looking for other diameters.

### DIAMETERS

THREAD COURSE	THREAD FINE	METRIC
2-56	04-48	2mm
3-48	6-40	3mm
4-40	8-36	5mm
5-40	10-32	6mm
6-32	12-28	8mm
8-32	1/4-28	10mm
10-24	5/16 -24	12mm
12-24	3/8 -24	14mm
1/4 -20	7/16 -20	16mm
5/16 -18	1/2 -20	18mm
3/8 -16	9/16 -18	20mm
7/16 -14	5/8 -18	22mm
1/2 -13	3/4 -16	24mm
9/16 -12	7/8 -14	27mm
5/8 -11	1 -14	30mm
3/4 -10		
7/8 -9		
1 -8		
1 1/8 -7		
1 1/4 -7		
1 3/8 -6		
1 1/2 -6		

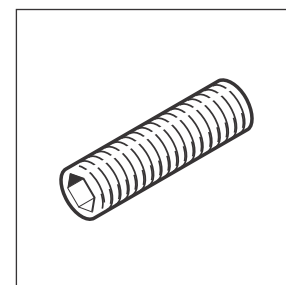

ASME/ANSI B18.3  
ASTM F912

DIN 916  
14.9 ALLOY 45H CUP POINT

ASME/ANSI B18.3  
ASTM F880  
304 STAINLESS

ASME/ANSI B18.3  
ASTM F880  
316 STAINLESS

### Fastener Finishes

Sockets are typically ordered in a black oxide or stainless steel. We also stock them with a blue xylan or zinc-plated finish. If you need to be supplied with another finish, then call or email us. We can provide finishes to your specification. We do it everyday.

### Technical Data

If you need a Technical Guide, then call or email us. We can provide your company with a Technical Guide that contains more specific information about mechanical qualities and strength.



# THE NUT PLACE

6605 N. Gessner Houston, TX 77040-4015

Ph: 713-462-3147

sales@thenutplace.com

www.thenutplace.com

## SOCKET SHOULDER

### AVAILABLE TYPES

Diameters available in standard and metric.

Call or email us if you're looking for other diameters..

### DIAMETERS

#### THREAD COURSE

1/4 -20

5/16 -18

3/8 -16

7/16 -14

1/2 -13

9/16 -12

5/8 -11

3/4 -10

7/8 -9

1 -8

1 1/8 -7

1 1/4 -7

#### METRIC

6mm

8mm

10mm

12mm

14mm

16mm

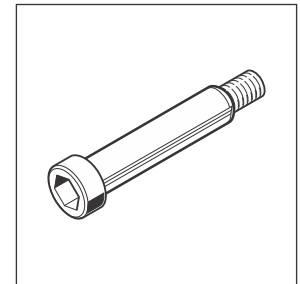

**ASME/ANSI B18.3**

**ASTM A574**

**ISO 7370**

**ALLOY STEEL**

**ASME/ANSI B18.3**

**ASTM F837**

**304 STAINLESS**

### Fastener Finishes

Sockets are typically ordered in a black oxide or stainless steel. We also stock them with a blue xylan or zinc-plated finish. If you need to be supplied with another finish, then call or email us. We can provide finishes to your specification. We do it everyday.

### Technical Data

If you need a Technical Guide, then call or email us. We can provide your company with a Technical Guide that contains more specific information about mechanical qualities and strength.