



THE NUT PLACE

6605 N. Gessner Houston, TX 77040-4015

Ph: 713-462-3147

sales@thenutplace.com

www.thenutplace.com

FLAT WASHERS- USS

AVAILABLE TYPES

FLAT WASHERS LOW CARBON USS CLEAR ZINC CR+3 or PLAIN

FLAT WASHERS MED. CARBON USS THRU-HARDENED YELLOW ZINC OR PLAIN

DIAMETERS

#2, #4, #6, #8, #10, #12

1/4
5/16
3/8
7/16
1/2
9/16
5/8
3/4
7/8
1
1 1/8
1 1/4
1 3/8
1 1/2
1 3/4
2
2 1/4

(COURSE, ZP AND/OR PLAIN)

3mm
4mm
5mm
6mm
7mm
8mm
10mm
12mm
14mm
16mm
18mm
20mm
22mm
24mm
27mm
30mm
36mm
42mm
45mm

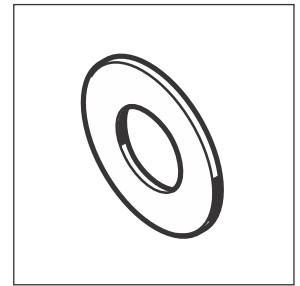

Fastener Finishes

Washers are available with different finishes like zinc, galvanized, xylan, cad or just plain black. If you need to be supplied with another finish, then call or email us. We can provide finishes to your specification.

Technical Data

If you need a Technical Guide, then call or email us. We can provide your company with a Technical Guide that contains more specific information about mechanical qualities and strength.



THE NUT PLACE

6605 N. Gessner Houston, TX 77040-4015

Ph: 713-462-3147

sales@thenutplace.com

www.thenutplace.com

FLAT WASHERS- SAE

AVAILABLE TYPES

FLAT WASHERS SAE LOW CARBON ZINC CR+3

FLAT WASHERS MED. CARBON SAE THRU-HARDENED ZINC-YELLOW

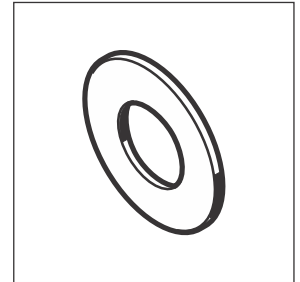

DIAMETERS

#10, #12

1/4

5/16

3/8

7/16

1/2

9/16

5/8

3/4

7/8

1

1 1/8

1 1/4

1 3/8

1 1/2

1 3/4

2

Fastener Finishes

Washers are available with different finishes like zinc, galvanized, xylan, cad or just plain black. If you need to be supplied with another finish, then call or email us. We can provide finishes to your specification.

Technical Data

If you need a Technical Guide, then call or email us. We can provide your company with a Technical Guide that contains more specific information about mechanical qualities and strength.



THE NUT PLACE

6605 N. Gessner Houston, TX 77040-4015

Ph: 713-462-3147

sales@thenutplace.com

www.thenutplace.com

LOCK WASHERS

AVAILABLE TYPES

SPLIT LOCK WASHERS ZINC CR+3 AND PLAIN.

SPLIT LOCK WASHERS ALLOY THRU-HARDENED ZINC-YELLOW AND PLAIN.

DIAMETERS

(ZP AND/OR PLAIN)

#4, #6, #8, #10, #12

1/4

5/16

3/8

7/16

1/2

9/16

5/8

3/4

7/8

1

1 1/8

1 1/4

1 3/8

1 1/2

1 3/4

2

2 1/4

(ZP AND/OR PLAIN)

3mm

4mm

5mm

6mm

10mm

12mm

14mm

16mm

18mm

20mm

22mm

24mm

27mm

30mm

36mm

39mm

42mm

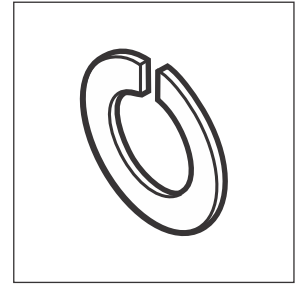

Fastener Finishes

Washers are available with different finishes like zinc, galvanized, xylan, cad or just plain black. If you need to be supplied with another finish, then call or email us. We can provide finishes to your specification.

Technical Data

If you need a Technical Guide, then call or email us. We can provide your company with a Technical Guide that contains more specific information about mechanical qualities and strength.



THE NUT PLACE

6605 N. Gessner Houston, TX 77040-4015

Ph: 713-462-3147

sales@thenutplace.com

www.thenutplace.com

HI-COLLAR LOCK WASHERS

AVAILABLE TYPES

HI-COLLAR SPLIT LOCK WASHERS MED. CARBON ZINC PLATED OR PLAIN

Call or email us if you're looking for other diameters.

DIAMETERS

(ZP AND/OR PLAIN)

#4, #6, #8, #10, #12

1/4

5/16

3/8

7/16

1/2

9/16

5/8

3/4

7/8

1

1 1/8

1 1/4

1 3/8

1 1/2

1 3/4

2

(ZP AND/OR PLAIN)

3mm

4mm

5mm

6mm

10mm

12mm

14mm

16mm

18mm

20mm

22mm

24mm

27mm

30mm

36mm

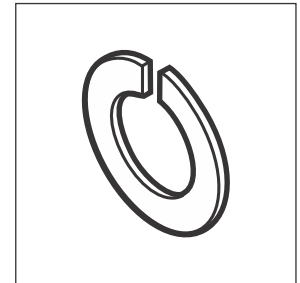

Fastener Finishes

Hi Collar Lock Washers are generally ordered with a plain finish. We also stock zinc-coated or blue xylan hi collar lock washers. If you need to be supplied with another finish, then call or email us. We can provide finishes to your specification.

Technical Data

If you need a Technical Guide, then call or email us. We can provide your company with a Technical Guide that contains more specific information about mechanical qualities and strength.



THE NUT PLACE

6605 N. Gessner Houston, TX 77040-4015

Ph: 713-462-3147

sales@thenutplace.com

www.thenutplace.com

F436 STRUCTURAL FLAT WASHERS

AVAILABLE TYPES

F436 STRUCTURAL FLAT WASHERS MED. CARBON
Call or email us if you're looking for other diameters.

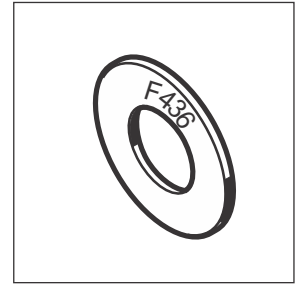

DIAMETERS

(ZP AND/OR PLAIN)

1/4
5/16
3/8
7/16
1/2
9/16
5/8
3/4
7/8
1
1 1/8
1 1/4
1 3/8
1 1/2
1 3/4
2
2 1/4

Fastener Finishes

F436 Flat Washers are generally ordered with a plain finish. We also stock zinc-coated or blue xylan hi collar lock washers. If you need to be supplied with another finish, then call or email us. We can provide finishes to your specification.

Technical Data

If you need a Technical Guide, then call or email us. We can provide your company with a Technical Guide that contains more specific information about mechanical qualities and strength.



THE NUT PLACE

6605 N. Gessner Houston, TX 77040-4015

Ph: 713-462-3147

sales@thenutplace.com

www.thenutplace.com

FENDER WASHERS

AVAILABLE TYPES

FENDER WASHERS

Call or email us if you're looking for other diameters or widths.

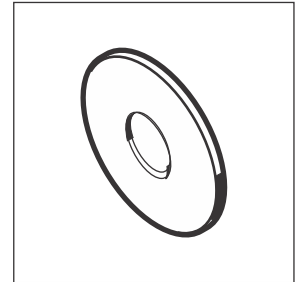

DIAMETERS

#10 X 3/4

#10 X 1

3/16 X 1

3/16 X 1 1/4

1/4 X 1

1/4 X 1-1/4

1/4 X 1-1/2

1/4 X 2

5/16 X 1 1/4

5/16 X 1 1/2

3/8 X 1

3/8 X 1 1/8

3/8 X 1 1/4

3/8 X 1 1/2

3/8 X 2

3/8 X 2 - 1/8 THICK

7/16 X 2

1/2 X 1-1/2

1/2 X 2

3/4 X 3

3/4 X 3 X 1/4

1 1/16 X 3 1/2 W/ 3/8" THICK

Fastener Finishes

Fender Washers are generally available with a zinc coating. If you need to be supplied with another finish, then call or email us. We can provide finishes to your specification.

Technical Data

If you need a Technical Guide, then call or email us. We can provide your company with a Technical Guide that contains more specific information about mechanical qualities and strength.



THE NUT PLACE

6605 N. Gessner Houston, TX 77040-4015

Ph: 713-462-3147

sales@thenutplace.com

www.thenutplace.com

SERRATED WEDGE LOCK WASHERS

AVAILABLE TYPES

SERR WEDGE LOCKWASHER

Serrated Wedge Lockwasher, also known as Nord-Lock (tm) washers work by securing bolted joints with tension instead of friction. It is a high quality product with documented success in many industries worldwide.

Call or email us if you're looking for other diameters.

DIAMETERS

(ZP AND/OR 316 SS)

#10
1/4
5/16
3/8
7/16
1/2
9/16
5/8
3/4
7/8
1
1 1/8
1 1/4
1 3/8
1 1/2
1 3/4
2

(ZP AND/OR 316 SS)

6mm
10mm
12mm
14mm
16mm
18mm
20mm
22mm
24mm
27mm
30mm
36mm

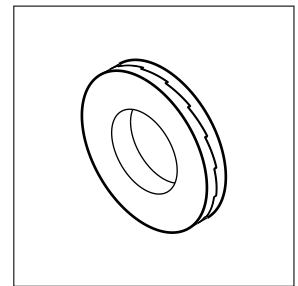

Fastener Finishes

Nord Lock washers are available in steel and stainless steel.

Technical Data

If you need a Technical Guide, then call or email us. We can provide your company with a Technical Guide that contains more specific information about mechanical qualities and strength.



THE NUT PLACE

6605 N. Gessner Houston, TX 77040-4015

Ph: 713-462-3147

sales@thenutplace.com

www.thenutplace.com

OTHER TYPES OF WASHERS

AVAILABLE TYPES

OTHER TYPES OF WASHERS

Nylon Washers, External Tooth Lock Washers, Internal Tooth Lock Washers, Bevel, Countersunk Finishing Washers, Belleville Washers, and more. We can find any type of washer you need. Call or email us for information.

Call or email us if you're looking for other washer types.

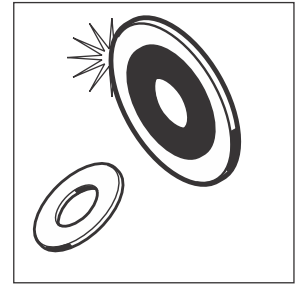

Technical Data

If you need a Technical Guide, then call or email us. We can provide your company with a Technical Guide that contains more specific information about mechanical qualities and strength.