



THE NUT PLACE

6605 N. Gessner Houston, TX 77040-4015

Ph: 713-462-3147

sales@thenutplace.com

www.thenutplace.com

GENERAL GUIDE FOR EYEBOLTS

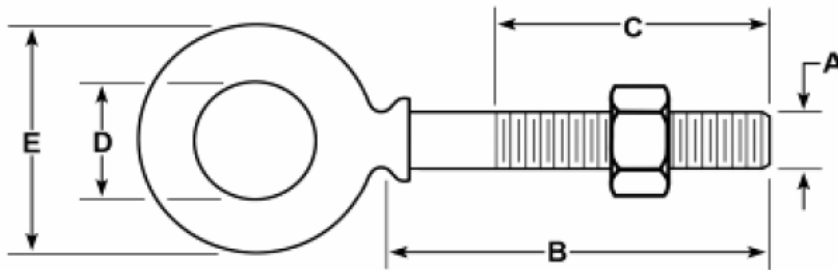

Forged carbon steel, heat treated, hot galvanized. Heavy hex nut according to ASME/ANSI B18.2.2.

Size Diameter x Shank A B	Working Load Limit in Pounds*	Approx. Weight each in Pounds	Dimensions in Inches		
			C	D	E
1/4" x 2"	650	.06	1.50	.50	.88
1/4" x 4"	650	.09	2.50	.50	.88
5/16" x 2.1/4"	1,200	.11	1.50	.63	1.13
5/16" x 4.1/4"	1,200	.15	2.50	.63	1.13
3/8" x 2.1/2"	1,500	.19	1.50	.75	1.38
3/8" x 4.1/2"	1,500	.25	2.50	.75	1.38
1/2" x 3.1/4"	2,600	.41	1.50	1.00	1.75
1/2" x 6"	2,600	.59	3.00	1.00	1.75
5/8" x 4"	5,200	.83	2.00	1.25	2.25
5/8" x 6"	5,200	1.00	3.00	1.25	2.25
3/4" x 4.1/2"	7,200	1.50	2.00	1.50	2.75
3/4" x 6"	7,200	1.70	3.00	1.50	2.75